

WARNING

1. Before start check if you have all components and tools.
2. Expedition-Gear will not be responsible for any damage caused by the failure to install the product.
3. Improper installation may result in bodily injury, death or car accident hence products must be checked prior to use, properly and securely assembled and attached to vehicle and periodically inspected.

Shelf mounting options

Expedition shelf may be mounted in two positions: bottom and top. Also, two shelves can be mounted in both positions at the same time. All possibilities are shown on the schemes below.

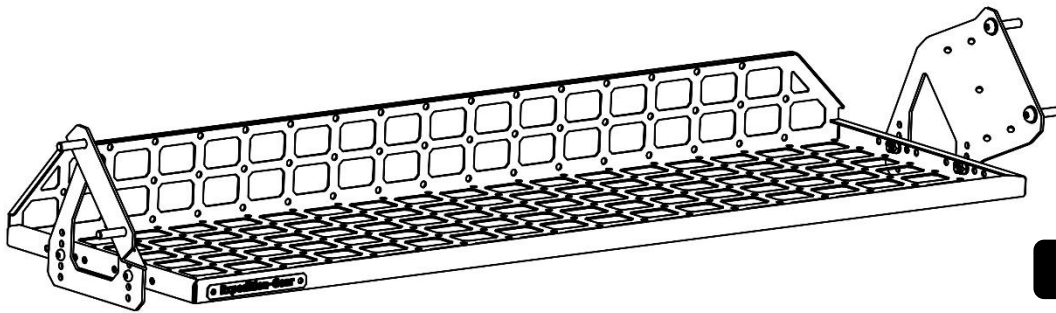

1. Bottom position

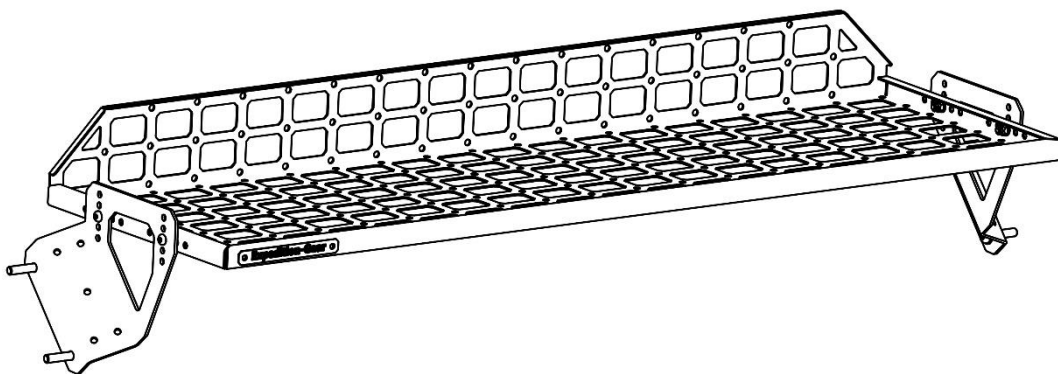

2. Top position

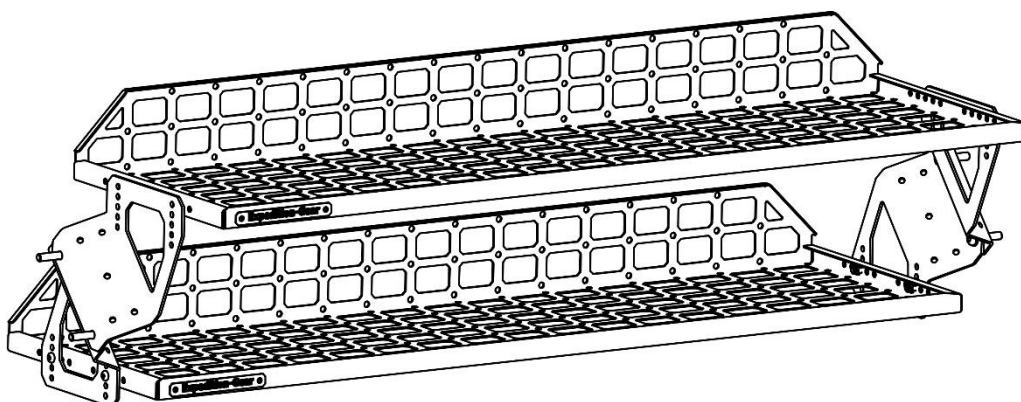

3. Top and bottom positions

STEPS

Below scheme shows top position (see figure 2). To mount in the bottom position, rotate the shelf mounts 180 degrees (as shown in figure 1).

1. Decide in which position your shelf will be mounted
2. Remove the plastic caps of the mounting sockets
3. Screw the mounts to them
4. Install the shelf to the mounts according to the scheme below
5. Send us picture after installation 😊 info@expedition-gear.com
6. Tag us on instagram @expedition.gear

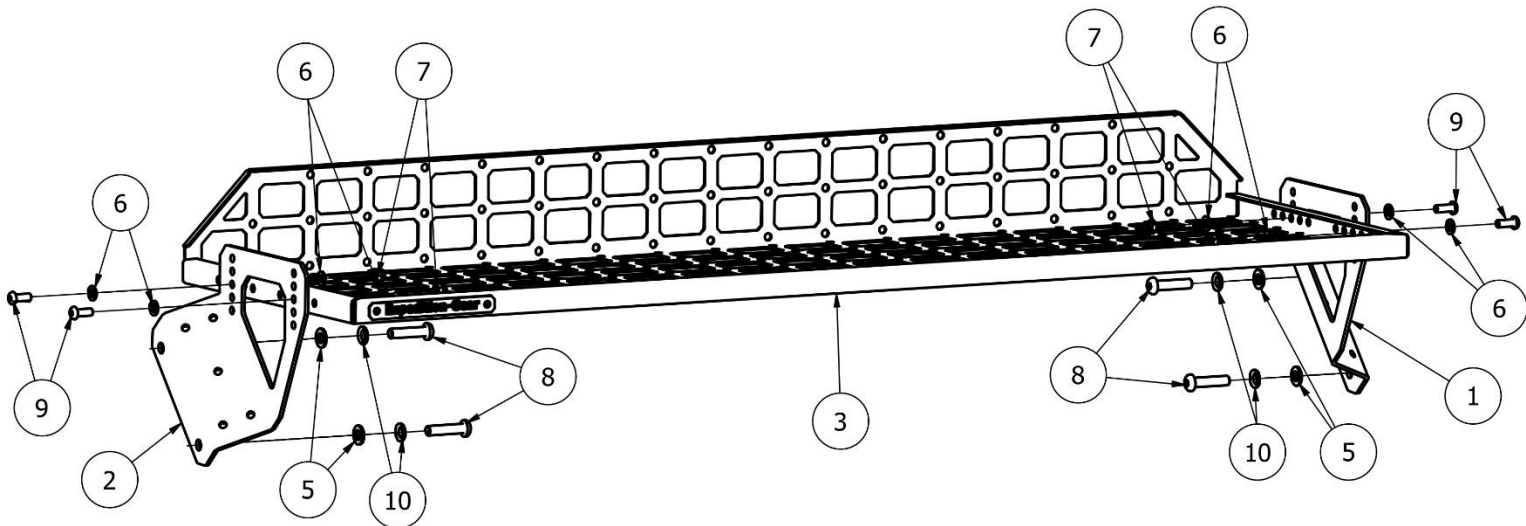

PART'S LIST	
PART NUMBER	PART
1	Right mount
2	Left mount
3	Expedition shelf
5	Wascher - M8
6	Wascher - M6
7	Nut - M6
8	Bolt - M8 x 35
9	Bolt - M6 x 16
10	Spring wascher - M8



TAG US! #accessoriesforadventure #expeditiongear